

# BIRCOplus | NW 100

## Light Concrete Channel – Ideal Laying

### Channel elements | 0.5 % internal inbuilt fall

- + Concrete edge not visible because of grating
- + Safety seam

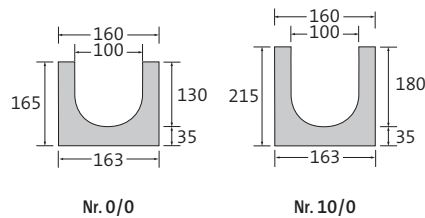

Description	Length	Width	Construction height at groove / tongue	Weight	Load class DIN EN 1433	Article no.
Channel no. 1	1000 mm	160 mm	165/170 mm	37.5 kg	A 15 – C 250	012001
Channel no. 2	1000 mm	160 mm	170/175 mm	38.3 kg	A 15 – C 250	012002
Channel no. 3	1000 mm	160 mm	175/180 mm	39.0 kg	A 15 – C 250	012003
Channel no. 4	1000 mm	160 mm	180/185 mm	39.8 kg	A 15 – C 250	012004
Channel no. 5	1000 mm	160 mm	185/190 mm	40.6 kg	A 15 – C 250	012005
Channel no. 6	1000 mm	160 mm	190/195 mm	41.4 kg	A 15 – C 250	012006
Channel no. 7	1000 mm	160 mm	195/200 mm	42.2 kg	A 15 – C 250	012007
Channel no. 8	1000 mm	160 mm	200/205 mm	43.0 kg	A 15 – C 250	012008
Channel no. 9	1000 mm	160 mm	205/210 mm	43.8 kg	A 15 – C 250	012009
Channel no. 10	1000 mm	160 mm	210/215 mm	44.6 kg	A 15 – C 250	012010

### Channel elements | without inbuilt fall

- + Concrete edge not visible because of grating
- + Safety seam

Description	Length	Width	Construction height at groove / tongue	Weight	Load class DIN EN 1433	Article no.
Channel no. 0/0	500 mm	160 mm	165/165 mm	19.0 kg	A 15 – C 250	012031
Channel no. 0/0	1000 mm	160 mm	165/165 mm	37.0 kg	A 15 – C 250	012026
Channel no. 5/0	1000 mm	160 mm	190/190 mm	41.0 kg	A 15 – C 250	012027
Channel no. 10/0	1000 mm	160 mm	215/215 mm	44.0 kg	A 15 – C 250	012028

Channel No. 0/0 and 5/0 also available with socket DN 100 for a vertical outlet. Art.-No. 012033 for a length of 1000 mm.

## End caps



Description	Width	For construction height	Weight	Article no.
End cap, galvanised, no. 0/0 – 2	160 mm	165 – 175 mm	0.3 kg	012090
End cap, galvanised, no. 3 – 6	160 mm	175 – 195 mm	0.3 kg	012091
End cap, galvanised, no. 7 – 10	160 mm	195 – 215 mm	0.4 kg	012092
End cap with outlet DN 100, galvanised, no. 0/0	160 mm	165 mm	0.6 kg	012045
End cap with outlet DN 100, galvanised, no. 5/0	160 mm	190 mm	0.7 kg	012046
End cap with outlet DN 100, galvanised, no. 10/0	160 mm	215 mm	0.8 kg	012047

## In-line outfall unit | 1-piece

- + 1- or 2-sided channel connection unit no. 10
- + PP silt bucket
- + PP odour trap
- + Integrated socket for DN 100 pipe connection

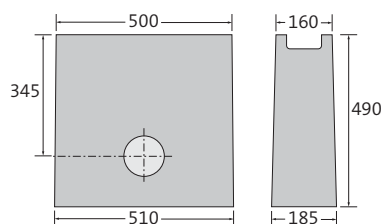

Description	Length	Width	Construction height	Weight	Load class DIN EN 1433	Article no.
until no. 10	500 mm	160 mm	490 mm	58.0 kg	A 15 – C 250	012035

## Slotted ductile iron grating

- + Black immersion-lacquered
- + 2 point per metre M12/A2 bolt connection with bolt clamp



Description	Length	Width	Weight	Inlet opening	Inlet cross section	Load class DIN EN 1433	Article no.
black	500 mm	158 mm	3.5 kg	SW 85/10 mm	312 cm <sup>2</sup> /m	A 15 – C 250	012070

Outlet openings, cuts on special length and mitre cuts available upon request.  
SW = slot width

### Slotted gratings

- + Galvanised
- + As clamped grating
- + 2 point per metre M12/A2 bolt connection with bolt clamp (alternatively)



Description	Length	Width	Weight	Inlet opening	Inlet cross section	Load class DIN EN 1433	Article no.
Clamp-type fastening	500 mm	158 mm	1.3 kg	SW 80/12 mm	334 cm <sup>2</sup> /m	A 15	012066
Clamp-type fastening	1000 mm	158 mm	2.4 kg	SW 80/12 mm	334 cm <sup>2</sup> /m	A 15	012056
Bolt fastening	500 mm	158 mm	1.5 kg	SW 80/12 mm	334 cm <sup>2</sup> /m	A 15	012067
Bolt fastening	1000 mm	158 mm	2.9 kg	SW 80/12 mm	334 cm <sup>2</sup> /m	A 15	012057

### Mesh gratings | clamped grating

- + Hot-dipped galvanised



Description	Length	Width	Weight	Inlet opening	Inlet cross section	Load class DIN EN 1433	Article no.
hot-dipped galvanised	500 mm	158 mm	1.7 kg	MW 30/16 mm	800 cm <sup>2</sup> /m	A 15 – B 125	012062
hot-dipped galvanised	1000 mm	158 mm	3.3 kg	MW 30/16 mm	800 cm <sup>2</sup> /m	A 15 – B 125	012052
hot-dipped galvanised	500 mm	158 mm	1.7 kg	MW 30/10 mm	720 cm <sup>2</sup> /m	A 15 – B 125	012063
hot-dipped galvanised	1000 mm	158 mm	3.4 kg	MW 30/10 mm	720 cm <sup>2</sup> /m	A 15 – B 125	012053

### Outfall unit 30/30 | 1-piece

- + 2-sided channel connection until No. 10
- + PP silk bucket
- + PP odour trap
- + Integrated socket for DN 100 pipe connection

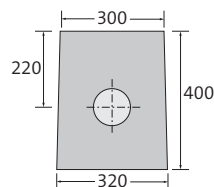

Description	Length	Width	Construction height	Weight	Load class DIN EN 1433	Article no.
until no. 10	300 mm	300 mm	400 mm	55.3 kg	A 15 – B 125	080105

Outlet openings, cuts on special length and mitre cuts available upon request  
SW = slot width, MW = mesh width

**Slotted grating** | clamped grating | for outfall unit 30/30

+ Galvanised

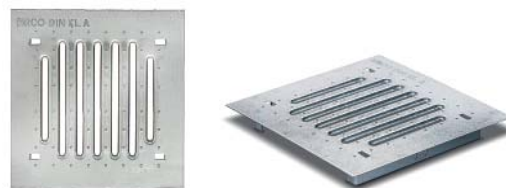

Description	Length	Width	Weight	Inlet opening	Einlauf- querschnitt	Load class DIN EN 1433	Article no.
Clamp-type fastening	300 mm	300 mm	1.4 kg	SW 185/10 mm	117 cm <sup>2</sup> /m	A 15	080117

**Mesh grating** | clamped grating | for outfall unit 30/30

+ Hot-dipped galvanised



Description	Length	Width	Weight	Inlet opening	Inlet cross section	Load class DIN EN 1433	Article no.
Clamp-type fastening	300 mm	300 mm	2.7 kg	MW 30/16 mm	489 cm <sup>2</sup> /m	A 15 – B 125	080116

**Outfall unit 19/19** | incl. ductile iron grating

- + PP silk bucket
- + PP odour trap
- + Integrated socket for DN 100 pipe connection
- + With ductile iron grating



Description	Length	Width	Construc- tion height	Weight	Load class DIN EN 1433	Article no.
Outfall unit incl. grating	230 mm	230 mm	205 mm	18.2 kg	A 15 – B 125	080100

Outlet openings, cuts on special length and mitre cuts available upon request  
 SW = slot width, MW = mesh width